

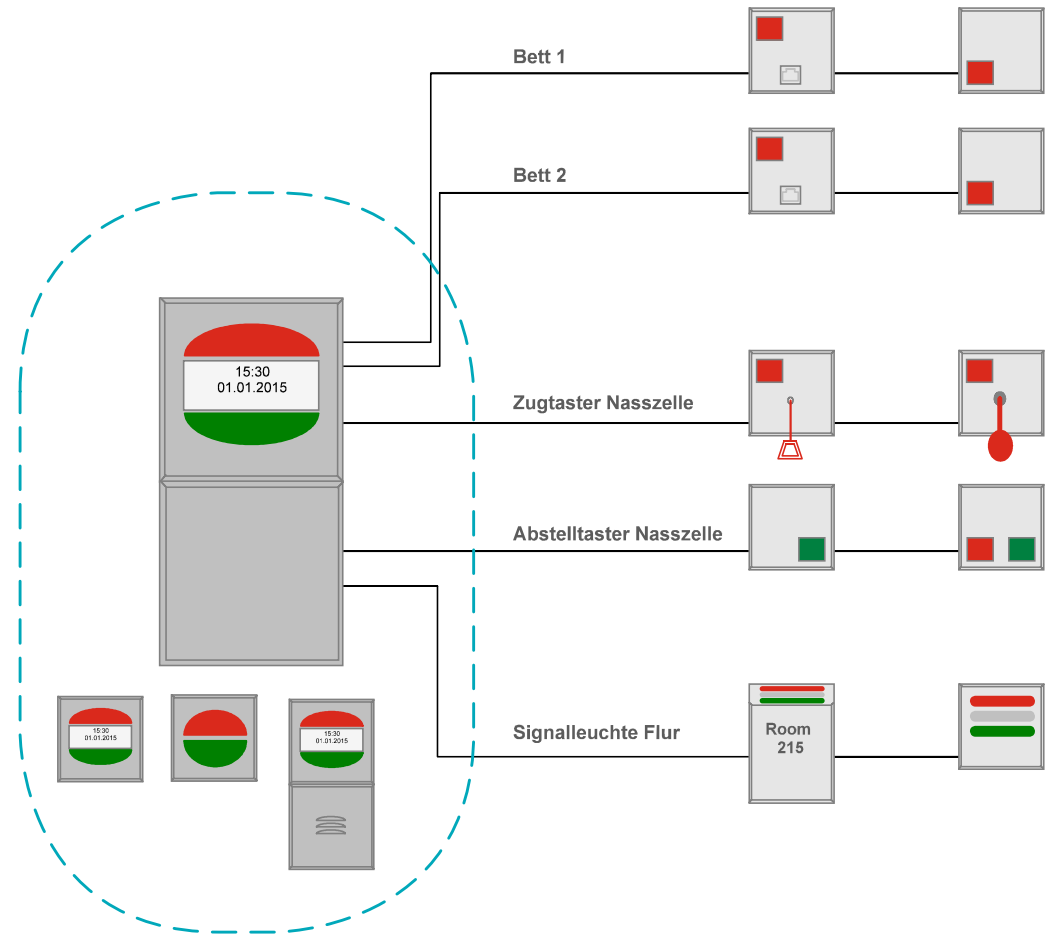

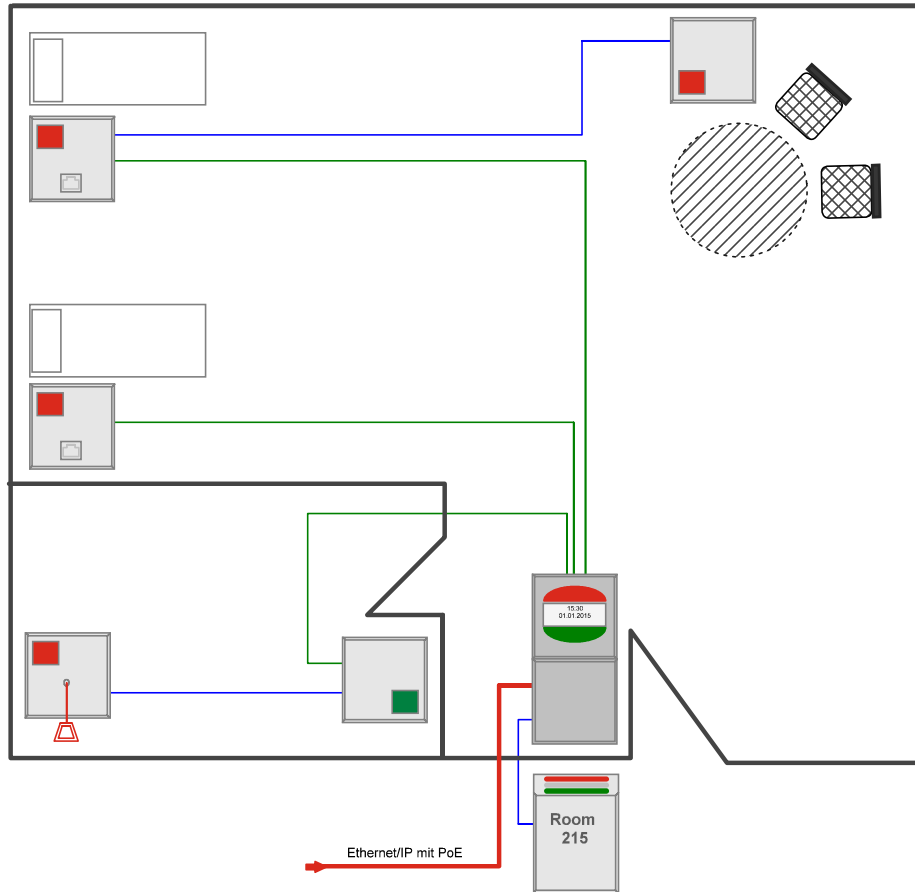

Systemübersicht PANA-MED NETpro IP

Sprachkommunikation: **NEIN** Verbindungsart: **IP**
Installation Zimmerelektronik: **Zimmerseitig**

Installation Doppelzimmer:



-  Kabeltyp mind. CAT.5 Ethernet PoE
-  Kabeltyp JY(ST)Y 2x2x0,6mm²
-  Kabeltyp JY(ST)Y 4x2x0,6mm²